

# CONFERENCES & EVENTS







## WELCOME TO HILTON LAKE TAUPO

Nestled in one of the world's most stunning natural regions, Hilton Lake Taupo is conveniently close to the bustling town centre, the famous hot springs and mighty Huka Falls. Combining Victorian charm with contemporary comfort and all-new meeting and business facilities, the hotel is a Central North Island landmark.

The area is rich in both cultural heritage and natural wonders, surrounded by rugged mountains on the edge of New Zealand's largest lake. For groups on an incentive trip, Lake Taupo offers abundant adventures.









LOCATION

From its spectacular vantage point, Hilton Lake Taupo features magnificent views over New Zealand’s largest lake, where mountains dominate the skyline. Conveniently located midway between Auckland and Wellington, it is 1km from the lake front along State Highway 5, in the Onekeneke Thermal Valley, overlooking the central plateau mountains beyond.



AT A GLANCE

GUEST ROOMS

Total number of rooms: 113

- Guest rooms: 28
- Guest rooms Plus: 28
- Deluxe rooms: 10
- King Junior suites: 19
- Relaxation suites: 3
- One-bedroom apartments: 19
- Three-bedroom apartments: 5
- Presidential suite: 1

AMENITIES & SERVICES

- High speed wired and wireless internet
- 32" LCD flat-screen TV
- Sky Sports 1, 2 and Sky Movies
- DVD
- Hairdryer
- Mini-bar
- Safety deposit box

ON-SITE LEISURE FACILITIES

- Thermally heated outdoor pool
- Spa Pool
- Sauna
- Steam Room
- Fitness centre
- Tennis courts

DINING & ENTERTAINMENT

Savour a meal at our flagship restaurant and bar Bistro Lago, featuring intimate and chic spaces designed to help you unwind. Relax by the open fire in winter, enjoy the stunning views from the verandah in summer and pull up a seat at the well-stocked bar anytime for a refreshing drink

NEARBY LEISURE FACILITIES

- Lake Taupo
- Walking in national parks
- Trout fishing
- Jet boating
- Bungy jumping
- Skydiving
- Championship golf
- Skiing
- Wine tasting
- Lake cruises
- Helicopter tours
- Thermal parks
- Maori cultural shows

LOCAL ATTRACTIONS

Lake Taupo offers an abundance of adventure and entertainment including:

- Thermal springs
- Craters of the Moon
- Huka Falls
- Tongariro National Park
- Mount Ruapehu and Turoa Ski Fields
- Motor Sport Park Formula Challenge
- Aratiatia Dam
- Scenic Cellar wine tasting experience
- Lake cruise

CHECK IN/OUT

Check-In: 3.00pm  
Check-Out: Noon  
Express Check-Out

GENERAL INFORMATION

Currency: NZ dollar  
Nearest airports:  
Taupo Domestic Airport - 15 minutes  
Rotorua International Airport - 55 minutes



MEETINGS & EVENTS

CAPACITIES & DIMENSIONS

	THEATRE	CABARET	COCKTAIL	CLASSROOM	U-SHAPE	BANQUET	BOARDROOM
The Terraces	260	136	430	153	57	200	72
The Terraces 1	160	80	270	87	40	120	57
The Terraces 2	88	48	150	54	36	60	42
The Library	48	16	90	24	-	20	20
The Library 1	18	8	40	12	-	10	10
The Library 2	18	8	40	12	-	10	10
The Study	18	8	40	9	-	10	10
Cellar Lounge	40	25	70	18	-	40	18
Boardroom	-	-	-	-	-	-	18



EVENT & MEETING ROOM FLOOR PLANS

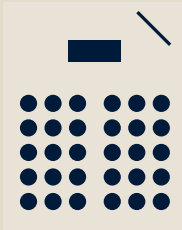

Theatre

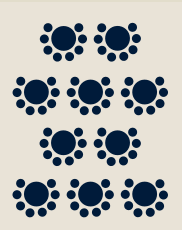

Cabaret

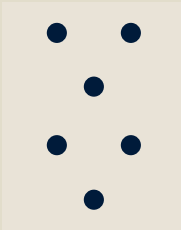

Cocktail

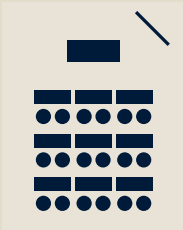

Classroom

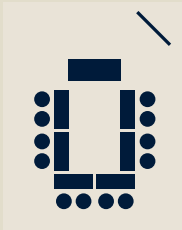

U-Shape

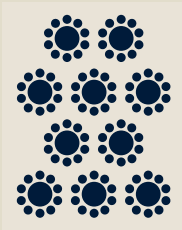

Banquet

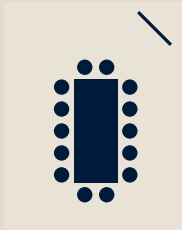

Boardroom



# MEETINGS & EVENTS

## FLOOR PLAN

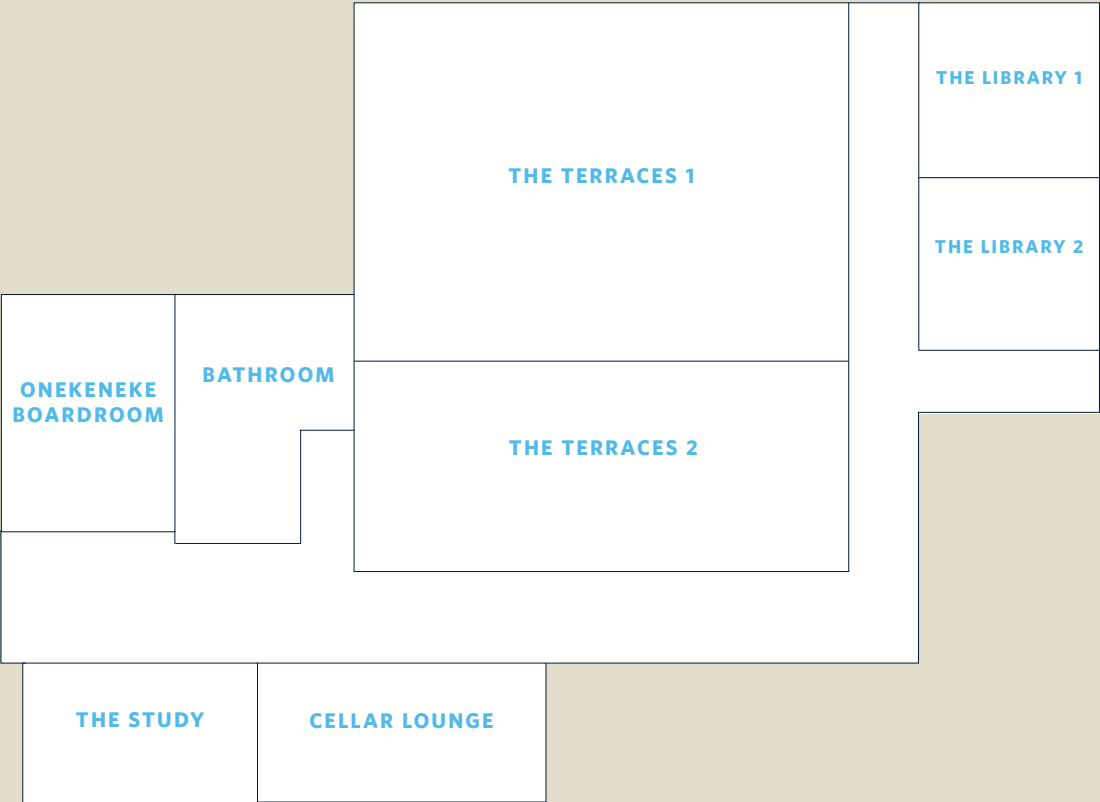

# ROOM HIGHLIGHT

## THE TERRACES

This large open plan ballroom is a very unique space, with French doors providing plenty of natural light. The room creates a stunning environment with all the requirements for your meeting.

With adjustable walls, The Terraces have the flexibility to accommodate up to 200 banquet style or be split into two smaller spaces. The adaptability of the space lends itself seamlessly to presentations, executive meetings, dinners and everything in between.

## THE LIBRARY

Boasting natural light and external access, The Library is the ideal venue for that private board meeting, video conference, client presentation or executive meetings. This flexible space can also be split into two rooms for more intimate meetings, seating up to 10 boardroom style.

## CELLAR LOUNGE

The elegant Cellar Lounge is adjacent to The Terraces. Enjoy stunning panoramic views over Lake Taupo and the mountains beyond or relax by the fireplace. Perfect for small intimate meetings, product launches, cocktail receptions and private dinners.

## ONEKENEKE BOARDROOM

Located on the ground floor of the hotel's Heritage Wing, the Onekeneke Boardroom offers a board style space for up to 18 guests with the latest in audio visual equipment. Located adjacent to The Study and restaurant Bistro Lago. Perfect for board meetings or private sit-down dinners.

## BREAKOUT SPACES

Our range of breakout spaces lend themselves to relaxing breaks with a panoramic outlook of the lake and mountains. A useful area for breaks, conference registrations or arrival drinks for your guests.

## BISTRO LAGO BAR AND RESTAURANT

Bistro Lago, our onsite restaurant and bar offers a multitude of intimate and elegant spaces in which to slow down and unwind. Relax by the roaring open fire in winter, pull up a seat at the bar or enjoy the vista from the expansive terrace during summer

[laketaupo.hilton.com](http://laketaupo.hilton.com)

**HILTON LAKE TAUPO**

80-100 Napier Road | Taupo | New Zealand

T: +64 7 378 7080 | F: +64 7 379 2352

E: [sales.laketaupo@hilton.com](mailto:sales.laketaupo@hilton.com)



AMERICAS • EUROPE • MIDDLE EAST • AFRICA • ASIA • AUSTRALASIA